

ITEM NO.	PART NUMBER	DESCRIPTION	MATERIAL	DRAWING #	QTY.
1	FI .375 X 1.25 L 2.75	LENGTH: 2-3/4"	FI 3/8x1-1/4"	STOCK	1
2	FP-LL STRAP 10.1875	LEVEL LOK MOUNTING STRAP 10-3/16"	ST-FI 3/8x2-3/4"	90-2821	1
3	RT 5x3x.1875 L 1.75	LENGTH: 1-3/4"	ST-RT 5x3x3/16	STOCK	1

**FP-FLL2-3 DS  
DRIVER SIDE FLL-2 REAR BRKT  
4.68 LBS.**

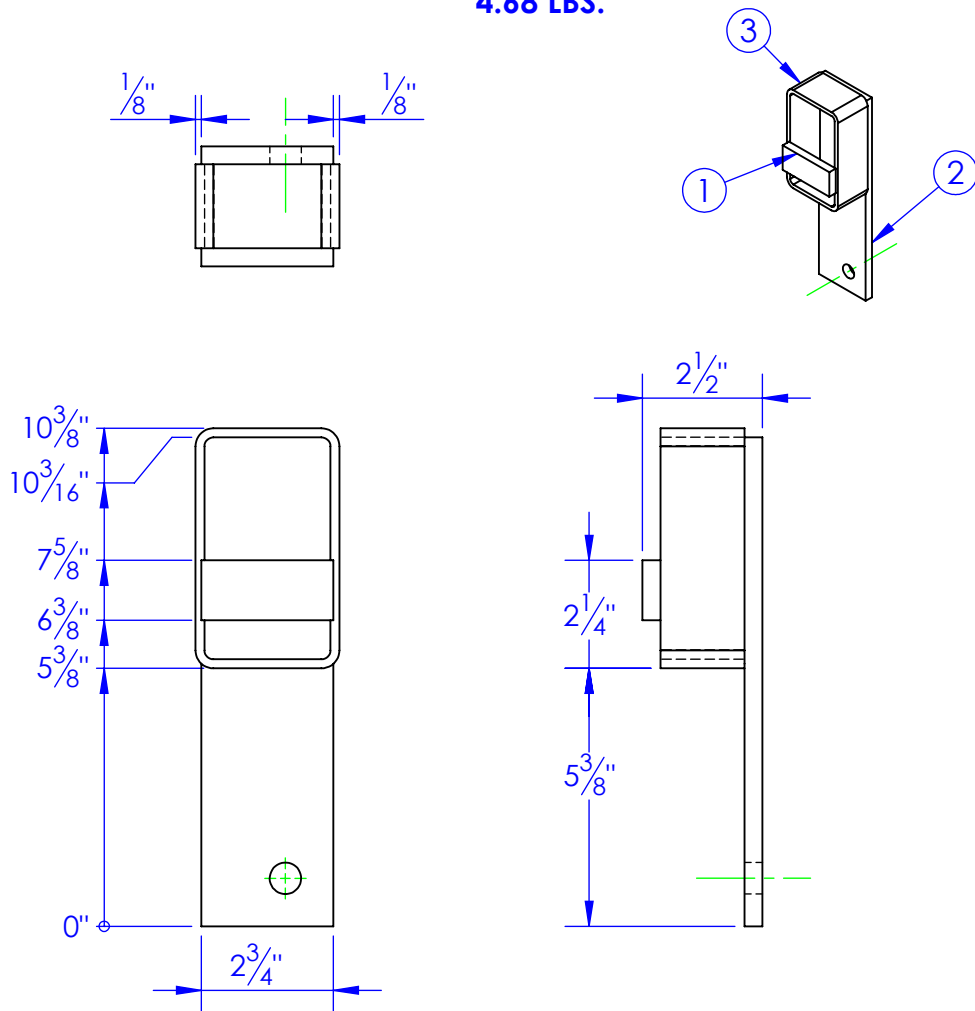

ITEM NO.	PART NUMBER	DESCRIPTION	MATERIAL	DRAWING #	QTY.
1	FI .375 X 1.25 L 2.75	LENGTH: 2-3/4"	FI 3/8x1-1/4"	STOCK	1
2	FP-LL STRAP 10.1875	LEVEL LOK MOUNTING STRAP 10-3/16"	ST-FI 3/8x2-3/4"	90-2821	1
3	RT 5x3x.1875 L 1.75	LENGTH: 1-3/4"	ST-RT 5x3x3/16	STOCK	1

**FP-FLL2-3 PS  
PASSENGER SIDE FLL-2 REAR BRKT  
4.68 LBS.**

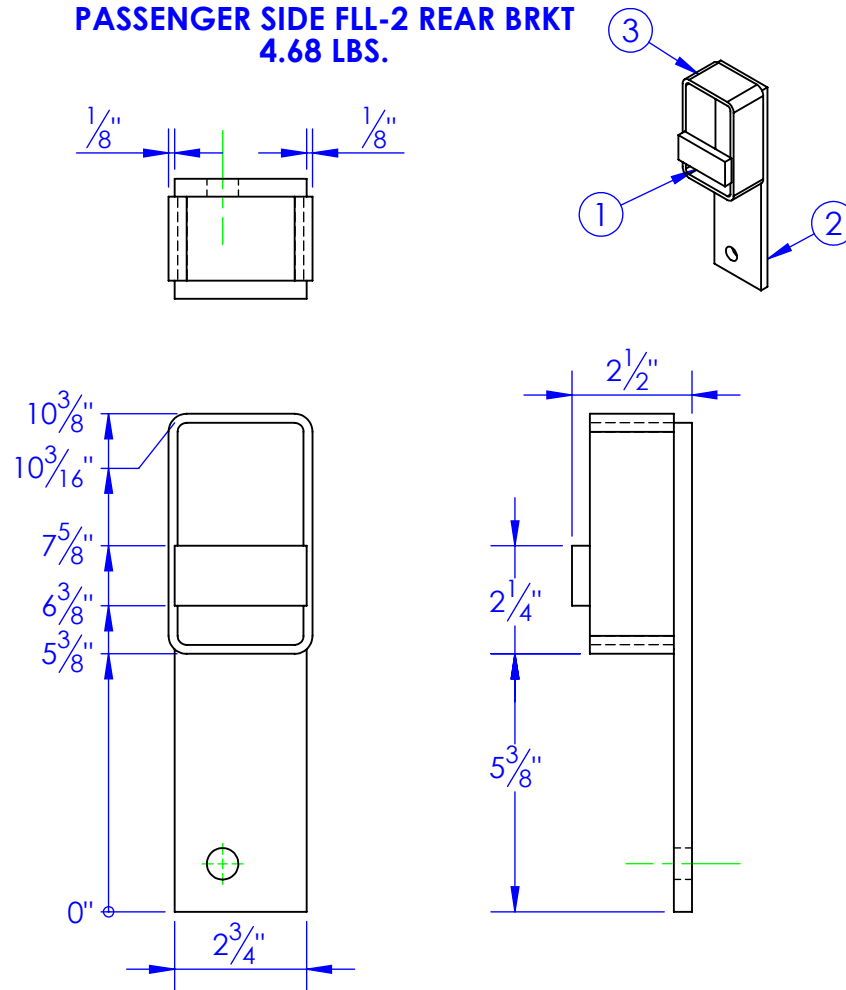

REV.	REVISIONS	DATE
A	UPDATED TO NEW DWG FROM 10-1845 B	1/22/2013

**PROPRIETARY AND CONFIDENTIAL**  
THE INFORMATION CONTAINED IN THIS DRAWING IS THE SOLE PROPERTY OF TRIPLE C INC. ANY REPRODUCTION IN PART OR AS A WHOLE WITHOUT THE WRITTEN PERMISSION OF TRIPLE C INC. IS PROHIBITED.

DIMENSIONS ARE IN INCHES TOLERANCES: FRACTIONAL $\pm 1/16$ ANGULAR: MACH $\pm 1$ BEND $\pm$ TWO PLACE DECIMAL $\pm 010$ THREE PLACE DECIMAL $\pm 005$	
MATERIAL	--
DO NOT SCALE DRAWING	

NAME	DATE
DRAWN	HEATH 1/28/2013
PART #	SEE DWG
ASM #	
COMMENTS:	
REAR BRACKET FLL-2 WLDMT.	

P.O. BOX 248, SABETHA, KS 66534	
<b>TRIPLE C</b> INC.	
SIZE A	DWG. NO. 90-1842-28
SCALE: 1:4	WEIGHT: --
REV. A	SHEET 1 OF 1